



PAR56

PAR56 300W GX16d 230V WFL 1CT

Extremely powerful pressed-glass 179 mm diameter reflector lamps

Product data

• General Characteristics

| | |
|--------------------|----------------------------|
| Cap-Base | GX16d |
| Bulb | PAR56 [PAR 7inch/180mm] |
| Operating Position | any [Any or Universal (U)] |
| Main Application | - |
| Gas Filling | GAS |
| Nominal Lifetime | 2000 hr |
| Rated Lifetime | 2000 hr |
| (hours) | |
| Rated Lifetime | 2 an |
| (years) | |

• Light Technical Characteristics

| | |
|---------------------------|---------------|
| Beam Description | Wide Flood |
| Beam Angle | 40 D |
| Beam Angle Technical | 40 D |
| Luminous Intensity | 9000 (max) cd |
| Color Rendering Index | 100 Ra8 |
| Color Temperature | 2700 K |
| Rated Luminous Flux | 2380 Lm |
| Rated Beam Angle | 40 D |
| Luminous flux in 90° cone | 2380 Lm |

• Electrical Characteristics

| | |
|--------------------------------|--------------------|
| Rated Wattage | 300.0 W |
| Lamp Wattage | 300 W |
| Voltage | 230 V |
| Dimmable | Yes |
| Starting Time | 0.0 s |
| Warm-up Time to 60% Light Outp | instant full light |

• Environmental Characteristics

| | |
|-------------------------------|---------|
| Energy Efficiency Label (EEL) | D |
| Energy consumption kWh/1000h | 300 kWh |

• Measuring Conditions

| | |
|-----------------|-------|
| Switching cycle | 8000X |
|-----------------|-------|

• Product Dimensions

| | |
|-----------------------|----------------|
| Overall Length C | 126.9 (max) mm |
| Overall Length Rim C1 | 98 mm |
| Diameter D | 178.5 (max) mm |

• Product Data

| | |
|-----------------------------|---------------------------------|
| Order code | 923804244221 |
| Full product code | 923804244221 |
| Full product name | PAR56 300W GX16d 230V WFL 1CT |
| Order product name | PAR56 300W GX16d 230V WFL 1CT/6 |
| Pieces per pack | 1 |
| Packing configuration | 6 |
| Packs per outerbox | 6 |
| Bar code on pack - EAN1 | 8711500159656 |
| Bar code on outerbox - EAN3 | 8711500159663 |
| Logistic code(s) - 12NC | 923804244221 |
| ILCOS code | IPAR-300-230-GX16d-179/40 |

PHILIPS

PAR56

Net weight per piece 513.000 gr

Dimensional drawing

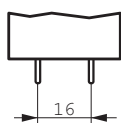
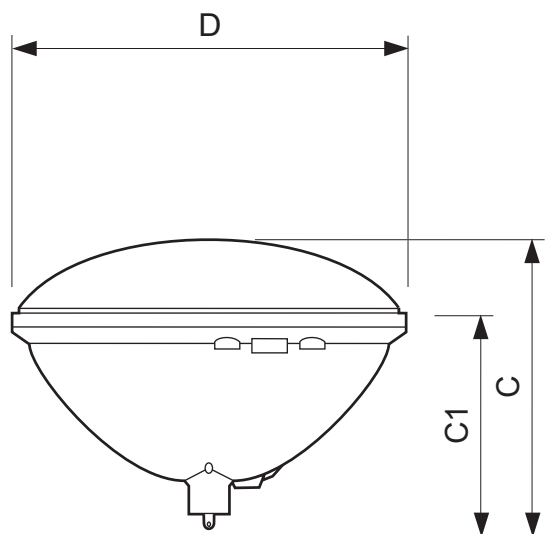

GX16d

PAR56 300W GX16d 230V WFL 1CT

| Product | C (Max) | C1 (Norm) | D (Norm) | D (Max) |
|---------------------------|---------|-----------|----------|---------|
| PAR56 300W GX16d 230V WFL | 126.9 | 98 | - | 178.5 |



© 2014 Koninklijke Philips N.V. (Royal Philips)
All rights reserved.

Specifications are subject to change without notice. Trademarks are the property of Koninklijke Philips N.V. (Royal Philips) or their respective owners.

www.philips.com/lighting

2014, February 6
data subject to change